



User's Manual

Little Friendlies 3-in-1 Baby Centre



© 2014 VTech
Printed in China

91-002945-001 

VTech understands that a child's needs and abilities change as they grow and with that in mind we develop our toys to teach and entertain at just the right level...

vtech Baby

Toys that will stimulate their interest in different textures, sounds and colours

I am...

...responding to colours, sounds and textures

...understanding cause and effect

...learning to touch, reach, grasp, sit-up, crawl and toddle

Birth-36 months



Pre-School

Interactive toys to develop their imagination and encourage language development

I want...

...to get ready for school by starting to learn the alphabet and counting

...my learning to be as fun, easy and exciting as can be

...to show my creativity with drawing and music so my whole brain develops

3-6 years



Electronic Learning Computers

Cool, aspirational and inspiring computers for curriculum related learning

I need...

...challenging activities that can keep pace with my growing mind

...intelligent technology that adapts to my level of learning

...National Curriculum based content to support what I'm learning at school

4-10 years



To learn more about this and other VTech® products, visit www.vtechuk.com

INTRODUCTION

Thank you for purchasing the **VTech® Little Friendlies 3-in-1 Baby Centre**

The **Little Friendlies 3-in-1 Baby Centre** by **VTech®** has three ways to play and grow with your child. Watch your little one get a workout as they grab the dangling animals in the baby gym. As they grow, the gym changes into a floor activity panel and a walker with interactive activities. The gym will teach colours, numbers, shapes and animals and can play lively and soothing music!

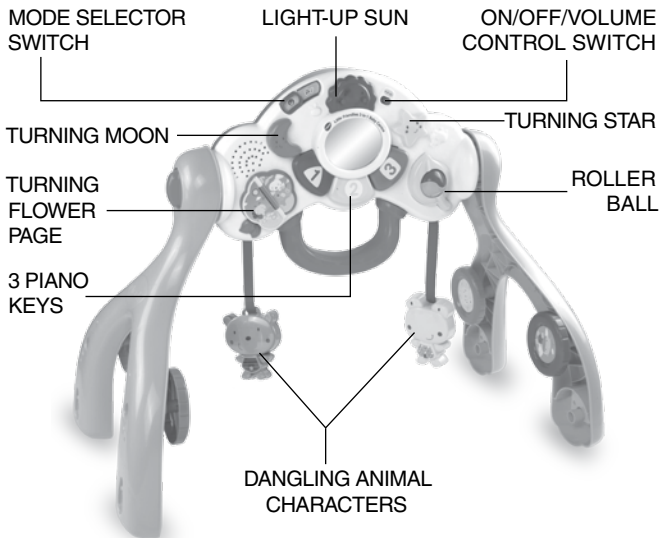

INCLUDED IN THIS PACKAGE

- One VTech® Little Friendlies 3-in-1 Baby Centre activity panel
- Two gym/walker legs
- Four colourful wheels
- One user's manual

WARNING:

All packing materials, such as tape, plastic sheets, packaging locks and tags are not part of this toy, and should be discarded for your child's safety.

Unlock the packing locks:

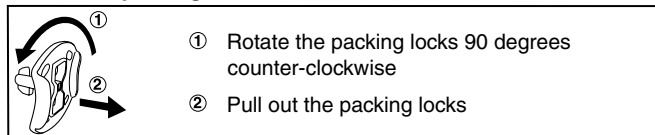

NOTE:

Please keep this user's manual as it contains important information.

GETTING STARTED

BATTERY INSTALLATION

1. Make sure the unit is turned **OFF**.
2. Locate the battery cover on the back of the activity panel. Use a coin or a screwdriver to loosen the screw.
3. Install 2 new 'AA' (AM-3/LR6) batteries following the diagram inside the battery box. (The use of new alkaline batteries is recommended for maximum performance.)
4. Replace the battery cover and tighten the screw to secure.

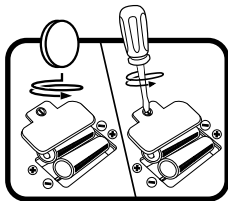

BATTERY NOTICE

- Use new alkaline batteries for maximum performance.
- Use only batteries of the same or equivalent type as recommended.
- Do not mix different types of batteries: alkaline, standard (carbon-zinc) or rechargeable (Ni-Cd, Ni-MH), or new and used batteries.
- Do not use damaged batteries.
- Insert batteries with the correct polarity.
- Do not short-circuit the battery terminals.
- Remove exhausted batteries from the toy.
- Remove batteries during long periods of non-use.
- Do not dispose of batteries in fire.
- Do not charge non-rechargeable batteries.
- Remove rechargeable batteries from the toy before charging (if removable).
- Rechargeable batteries are only to be charged under adult supervision.

Disposal of batteries and product



The crossed-out wheellie bin symbols on products and batteries, or on their respective packaging, indicates they must not be disposed of in domestic waste as they contain substances that can be damaging to the environment and human health.



The chemical symbols Hg, Cd or Pb, where marked, indicate that the battery contains more than the specified value of mercury (Hg), cadmium (Cd) or lead (Pb) set out in Battery Directive (2006/66/EC).

The solid bar indicates that the product was placed on the market after 13th August, 2005.

Help protect the environment by disposing of your product or batteries responsibly.

For more information, please visit:

www.recycle-more.co.uk

www.recyclenow.com

With the VTech® Little Friendlies 3-in-1 Baby Centre, safety comes first. To ensure your child's safety, adult assembly is required.

Please ensure that the legs and activity panel are securely locked into position to avoid injury.

ASSEMBLY INSTRUCTIONS

1. TO ASSEMBLE THE BABY CENTRE

To assemble the baby centre in the GYM position, insert the activity panel on to the legs and turn the screws to secure the legs.

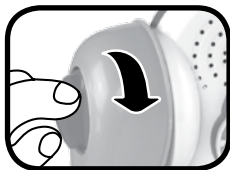
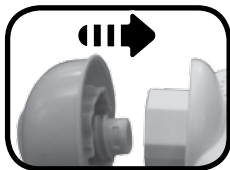

2. TO CONVERT THE BABY CENTRE

Release the lock on the activity panel by pressing the small button on the bottom of the main panel and loosen the screw plugs simultaneously. Then move the activity panel to the required angle and tighten the screws. The activity panel can be set at different angles for gym play, sitting play and walker play.

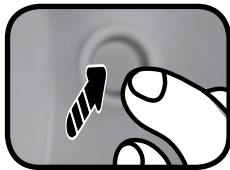
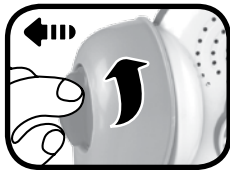

- a). To assemble the gym position, insert the activity panel on to the legs so the activity panel is at 45 degrees or 90 degrees. Turn the screws to secure the legs. Insert the four wheels in the upper position.

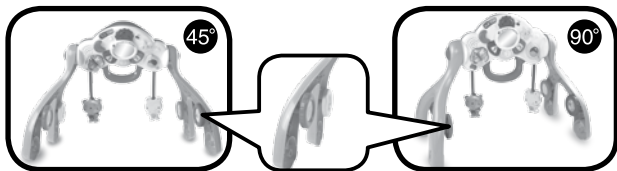

- b). To assemble the walker position, insert the activity panel into the legs so the activity panel is at 180 degrees. Turn the screws to secure the legs. Insert the 4 wheels into the recessed slots on the bottom of the walker legs. You will hear the wheels click into place when inserted correctly. Please check to make sure all the wheels are secure before using the walker.

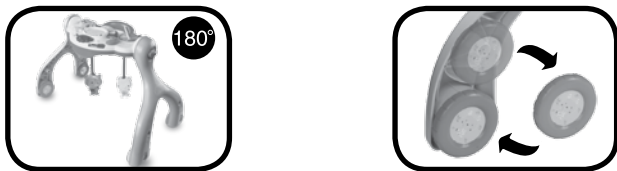

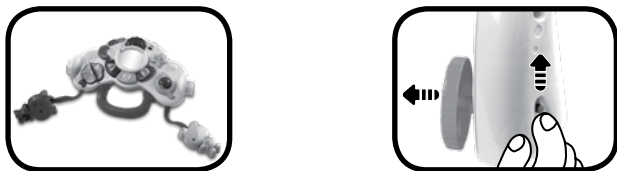

3. TO DISASSEMBLE FROM GYM OR WALKER

To play with the activity panel, remove the legs and place the activity panel on the floor. Push the little button on the legs up to pull out the wheels.



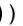

PRODUCT FEATURES

1. ON/OFF/VOLUME CONTROL SWITCH

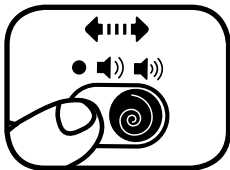
To turn the unit **ON**, slide the **ON/OFF/VOLUME CONTROL SWITCH** to the **LOW VOLUME** () or **HIGH VOLUME** () position. To turn the unit **OFF**, slide the **ON/OFF/VOLUME CONTROL SWITCH** to the **OFF** () position.



2. MODE SELECTOR SWITCH

Slide the **MODE SELECTOR SWITCH** to the **LEARNING MODE** () or the **MUSIC MODE** () position to choose a mode of play.

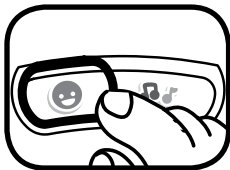

3. MOTION SENSOR

The **MOTION SENSOR** is located inside the activity panel. When the unit is in the walker mode position, push the walker to hear fun sounds talking phrases and playful music.



4. AUTOMATIC SHUT-OFF

To preserve battery life, the **VTech® Little Friendlies 3-in-1 Baby Centre** will automatically power-down after approximately 60 seconds without input. The unit can be turned on again by pressing any button. Moving the walker will not turn the unit back on.

ACTIVITIES

1. Slide the **on/off/volume control switch** to turn the unit on, then slide the mode selector switch to choose a mode of play. You will hear fun sounds, talking phrases and playful sing-along songs. The light will flash with the sound.

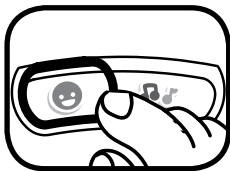
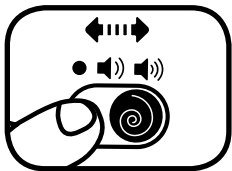

2. Press the **piano keys** to learn colours, numbers and shapes and hear piano sounds in the Learning Mode. In the Music Mode, you will hear piano notes in the walker position or long playing melodies in the gym position. When the melodies are playing, press the piano keys to play the melodies one note at a time. The light will flash with the sound.

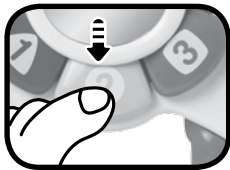

3. Turn the **flower page** to learn animals and hear fun sing-along songs and melodies in the Learning Mode. In the Music Mode, you will hear sounds and sing-along songs in the walker position and soothing melodies in the gym position. The light will flash with the sound.



4. Spin the **roller ball** to hear a variety of sounds in the Learning Mode and short tunes in the Music Mode. The light will flash with the sound.



5. Swing the **dangling animals** in the Learning Mode to hear sounds and phrases in the walker position and sounds and short tunes in the gym position. In the Music Mode, you will hear long playing playful music in the walker position and long playing soothing music in the gym position. The light will flash with the sound.

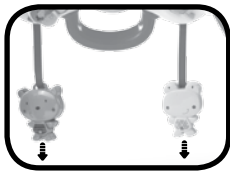

6. Activate the motion sensor in the walker position to hear fun sounds, phrases and playful music. Continue moving the walker while a melody is playing to hear fun sounds play over the melody. The light will flash with the sound.



MELODY LIST

Soothing Melodies

1. Home Sweet Home
2. Pachelbel's Cannon in D
3. Moonlight Sonata
4. Twinkle, Twinkle, Little Star
5. Rock-A-Bye Baby
6. The Green Grass Grew All Around

Playful Melodies

7. Waltz of the Flowers
8. Hickory Dickory Dock
9. Ring Around the Rosy
10. Three Blind Mice
11. Here We Go 'Round the Mulberry Bush
12. Yellow Rose of Texas
13. Mary Had a Little Lamb
14. She'll Be Comin' Round the Mountain
15. Old King Cole
16. Tarara Boom De Ay
17. Daisy Bell
18. Little Boy Blue
19. Oh Susanna
20. Little Bo Peep

SING-ALONG SONG LYRICS

SONG 1

Big bright sun, big bright sun,
Shining on me with your light,
Big bright sun!

SONG 2

I am happy to see you today.
Let's sing and giggle and play!

SONG 3

A-B-C tumble down D,
Birdie's in the sky flying free.

SONG 4

Hoot, hoot, hoot, owl's sitting in the tree!

CARE & MAINTENANCE

1. Keep the unit clean by wiping it with a slightly damp cloth.
2. Keep the unit out of direct sunlight and away from any direct heat source.
3. Remove the batteries when the unit will not be in use for an extended period of time.
4. Do not drop the unit on hard surfaces and do not expose the unit to moisture or water.

TROUBLESHOOTING

If for some reason the program/activity stops working or malfunctions, please follow these steps:

1. Please turn the unit **OFF**.
2. Interrupt the power supply by removing the batteries.
3. Let the unit stand for a few minutes, then replace the batteries.
4. Turn the unit **ON**. The unit should now be ready to play again.
5. If the product still does not work, replace with an entire set of new batteries.

If the problem persists, please call our Consumer Services Department on 01235 546810 (from UK) or +44 1235 546810 (outside UK) and a service representative will be happy to help you.

IMPORTANT NOTE:

Creating and developing **VTech®** products is accompanied by a responsibility that we take very seriously. We make every effort to ensure the accuracy of the information which forms the value of our products. However, errors sometimes can occur. It is important for you to know that we stand behind our products and encourage you to call our Consumer Services Department on 01235 546810 (from UK) or +44 1235 546810 (outside UK) with any problems and/or suggestions that you might have. A service representative will be happy to help you.



**CLASS 1
LED PRODUCT**



PRODUCT WARRANTY



Thank you for choosing this quality product from VTech. We hope it will bring many hours of entertainment, imaginative play and learning.

1. The product detailed above is covered by a one year warranty from the date of purchase, against any defects in materials or workmanship.
2. The product may be returned to the place of purchase. Alternatively the product can be returned to VTech Electronics Europe plc (see address below), with proof of purchase, without proof of purchase no replacement will be provided.
3. VTech Electronics Europe plc will examine the product and if it is found to be defective due to faulty materials or workmanship, will replace the product at their discretion.
4. If the product covered by this warranty is damaged due to misuse, modification or unauthorised repair, or because of faulty batteries, battery discharge or incorrect electrical connections, then this warranty becomes void.
5. This warranty is personal to the original purchaser and is not transferable.
6. Breakages to the LCD screen are not covered by the warranty.
7. Returns to VTech Electronics Europe plc should include a cheque or postal order for £1.50 towards the cost of return postage and packaging.
8. Products returned to VTech Electronics Europe plc, should be addressed as follows and packed carefully to avoid damage in transit (Please do not include batteries or adaptor).
Please include details of the fault together with your name and address.

VTech Electronics Europe plc, c/o Tablogix Limited, 200 Milton Park, Abingdon, Oxon OX14 4TA

THIS WARRANTY IS OFFERED AS AN EXTRA BENEFIT AND DOES NOT AFFECT CONSUMERS' STATUTORY RIGHTS.

This warranty is valid for the UK and Eire only. For products purchased outside the UK and Eire, please contact your local distributor or place of purchase.

